

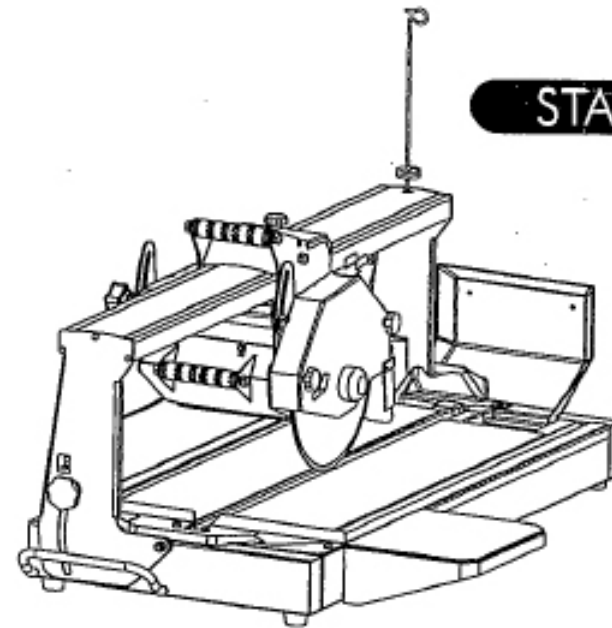

PRODUCTS

STALLION
27" Bridge Tile and Stone Wet Saw



STALLION

Before operating the unit, please read this manual thoroughly, and retain it for future reference.

TABLE OF CONTENTS

PAGE

CONTENTS	
Safety Precautions	1
General Safety Rules	2
Health Warnings	3
Unpack, Assembly & Set-Up	4
Specifications	5
Features	6
Saw Stand Assembly	7
Blade Installation	8
Cutting Head Installation	9
Side Table 'N Splash Guard Installation	9
Water Pump Installation	10
Water Level Tube	10
The Rip Guide	11
Operating the Saw	11
The Cutting Table	13
Cutting Depth	14
Choose the Right Blade	14
Electric Motor Specifications	15
Optional Accessories	16
Do's & Don'ts for Blades	17
Saw Maintenance	19
Water Pump Maintenance	22
Troubleshooting	23
Notes	26
Warranty	27
Replacement Parts List	29
Spanish Version Version en Español	

SAFETY PRECAUTIONS

Saw blade should be inspected daily for excessive wear, core cracks, and arbor damage. Replace any blade that shows signs of damage.

- To mount blade, clean arbor and outer flanges, tightening nut securely.
- DO NOT place any portion of body in line with blade while it is rotating.
- Wet cutting blades must be used with water.
- To reduce risk of electrical shock, we recommend the use of GFCI and to refer servicing to qualified professional.

OUR COMPANY recommends the use of these Safety Items when operating the Saw:



WEAR HEARING PROTECTION



WEAR EYE PROTECTION



USE BLADE GUARD WHEN OPERATING SAW



WEAR BREATHING PROTECTION

GENERAL SAFETY RULES

- Never use the machine improperly or work in an unsafe manner.
- Always wear safety goggles, dust mask, and ear protection while operating the saw (to comply with ANSI-Z87.1).
- Always remain alert when the saw is in use. Failure to pay attention on the operator's part may lead to serious injury.
- Before you start working, familiarize yourself with the work site and its surroundings. Take notice of circumstances which may impede working or traffic, observe soil conditions (good bearing or not), and take measures to ensure safety (i.e. the shielding of roadworks from public traffic).
- Take measures to ensure that the machine is in a safe and trouble-free condition prior to usage. Use the machine only when all protective devices (i.e. guards, noise absorbers, emergency-off devices) are operating in the intended locations.
- A visual check of the machine must be made at least once a shift to ensure that visible damages or faults are recognized. Any changes (including changes in the performance or behavior of the machine) must be reported to the supervisor. If necessary, stop the machine at once and secure it.
- In the case of a malfunction stop the machine immediately and secure it. Fix the problem as soon as possible.
- For starting and stopping the machine follow the operating instruction steps and observe any indicator lights.
- Before switching the machine on make sure that the activated machine will be off no danger to anyone.
- Be sure to connect the plug to a properly grounded receptacle to reduce the risk of electric shock.

HEALTH WARNINGS:

Some dust are created by power sanding, sawing, grinding, drilling, and cause other construction activities contains chemicals known to cause cancer, birth defects or other reproductive harm. Some examples of these chemicals are:

- Lead from lead based paints
- Crystalline silica from bricks and cement and other masonry products
- Arsenic and chromium from chemically-treated lumber

Your risk from these exposures varies, depending on how often you do this type of work. To reduce your exposure to these chemicals: work in a well ventilated area, and work with approved safety equipment, such as those dust masks that are specially designed to filter out microscopic particles.

UNPACK, ASSEMBLY & SET-UP

UNPACK

Open the container, carefully lift the saw frame handles and place it on a flat, level working area. Be certain that if you have the following items before you discard the container:

- Saw
- Slide-In Legs with Wheels
- 10" Saw Blade
- Multiple Rip Guide
- Multiple Wrench
- Water Pump
- Water Level Tube
- Owner's Manual
- Drain Plug
- Bucket (Optional)

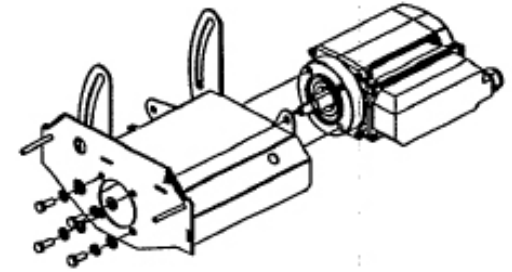

Proceed to the following section to complete assembly of the saw.

ASSEMBLY & SET-UP

1. Remove the carton box cover from the wooden frame.
2. Remove saw from the crate.
3. Loosen the lock knob on top of the cutting head.
4. Install the side extension table, side splash guard and back splash guard.
5. Install the spring holder on top of the sliding rail to hold the power cable and the water hose.
6. Fill the tray with water before operating the saw.

SPECIFICATIONS

The Stone/Tile Saws are professional saws used for cutting floor tiles, paving stones, stairs, larged-sized natural stones, and similar materials.

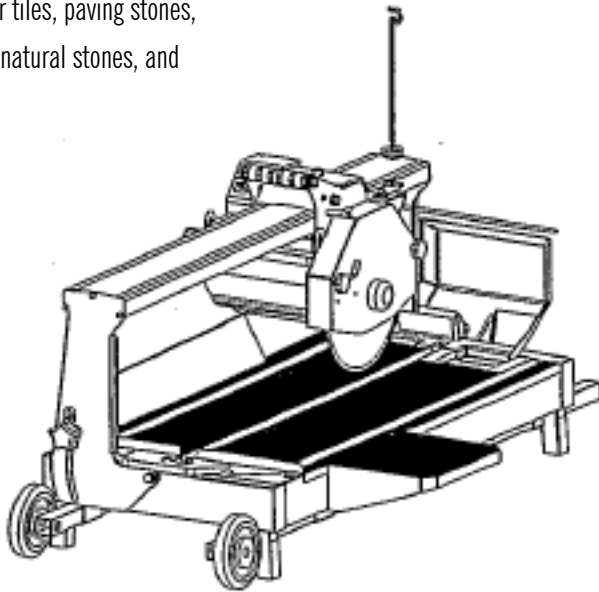

SPECIFICATIONS

SPECIFICATIONS	STALLION
Horse Power	1-1/2 HP
Volts	15 Volts
Amps	15 A
Hertz (Cycles)	60 Hz
Motor Type	Induction Motor
Stand	Optional Folding Stand
RPM	3450 rpm
Maximum Blade Size	8" - 10"
Arbor Size	5/8"
Maximum Depth of Cut	2-5/8"
Straight Cut Length	27"
Diagonal Cut Length	19"
Weight	115 lbs.

FEATURES

The Stone/Tile Saws are professional saws used for cutting floor tiles, paving stones, stairs, larged-sized natural stones, and similar materials.

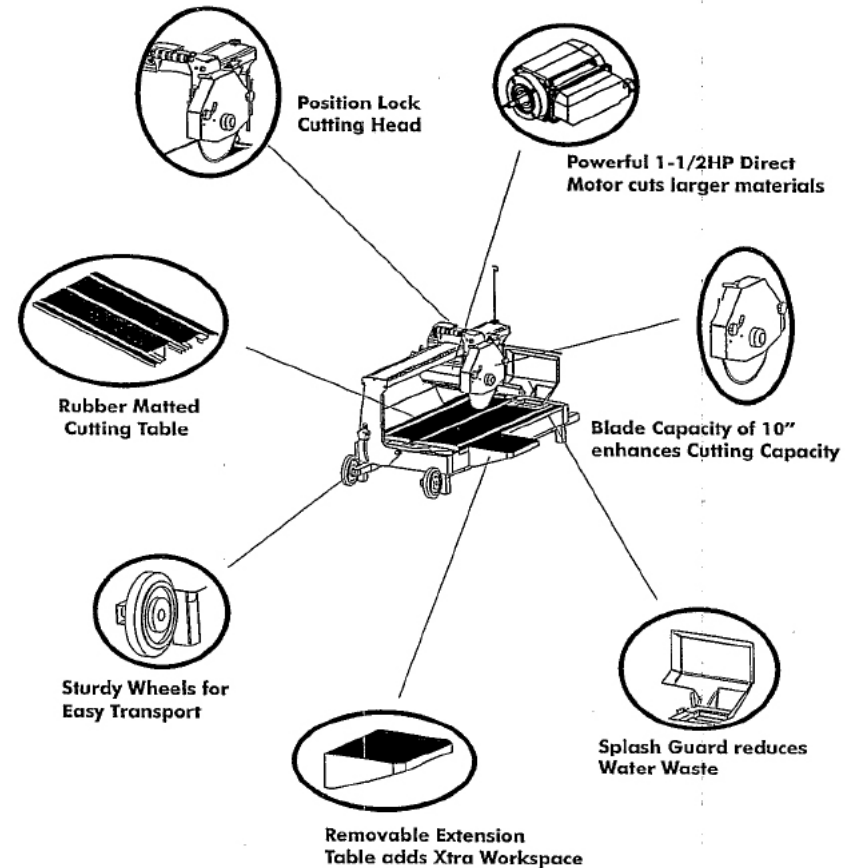

SAW STAND ASSEMBLY

FOLDING STAND (1027)

1. Remove the folding stand from its box.
2. Swing the working bench up-right. Open the two legs and place the work bench on top of the folding stand.
3. After the saw stand is completely assembled, place the saw on top of the saw stand.



SLIDE-IN LEGS

1. Lifting up on side of the saw, slide in the legs (with no wheels) to the front side of the saw. Lock the wing nut to tighten the legs in place.
2. Lift up the other side of the saw and slide in the legs with the wheels. Lock the wing nut to fasten the legs in place.

EASY TRANSPORT

1. Unlock the wing nut. Lift up the back side of the saw and slide the legs with wheels, lock the wing nut.
2. Go to the other side of the saw and unlock the wing nut. Lift up the other side of the saw and insert the legs, lock the wing nut. Using the legs as handles, tilt the saw diagonally and roll the saw on the wheels like a dolly.

BLADE INSTALLATION

1. Loosen the knurled nuts securing the blade guard and remove the guard.
2. Loosen the cutting shaft nut (left-hand thread); while loosening the nut, block the cutting shaft from turning.
3. Remove the blade clamping flange. Check that the contact area between the blade holder assembly and the diamond saw blade is clean.
4. Install the saw blade on the supporting flange, ensuring the correct sense of rotation marked by the arrow on the blade.
5. Install the blade clamping flange.
6. Retighten the cutting shaft nut. Block the cutting shaft from turning while tightening the nut.
7. Lightly turn the installed saw blade by hand and check the blade for true running.
8. Mount the blade guard.

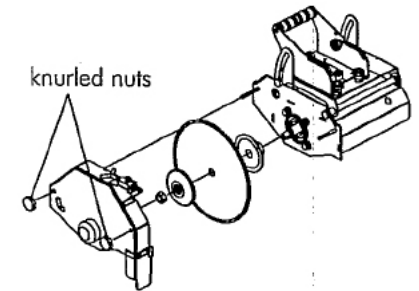

WARNING

SETTING THE BLADE TOO LOW MAY DAMAGE THE CUTTING TABLE AND IF SET TOO HIGH, THE BLADE MAY GRAB THE MATERIAL BEING CUT, CAUSING DAMAGE AND POSSIBLY INJURY.

CUTTING HEAD INSTALLATION

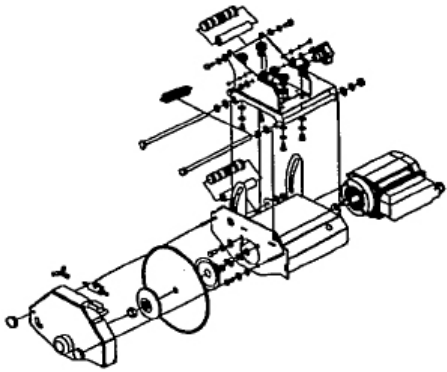

1. Slide the motor into the body of the cutting head mainframe, holding the motor front (outer) ring inset into the mainframe bracket.
2. Holding the cutting head steady, insert 4 bolts onto the front end of the motor through the cutting head mainframe. Lock the bolts tight to hold the motor in position.
3. Insert the inner flange onto the blade shaft against the motor's front end.

4. Place the blade onto the shaft making sure the directional arrows are pointing in the direction of the shaft rotation. Secure in place with the outer flange and blade shaft nut.
5. Insert the main long bolt in the upright of the front plate while holding the cutting head mainframe, lock it tight in position. Insert the second long bolt into the height adjustment slot and lock it tight in position. Place the tension spring into position for height adjustment.

SIDE TABLE & SPLASH GUARD INSTALLATION

Install the side table and splash guard as shown in the illustration to the side. Fasten the screws respectively to the saw frame.

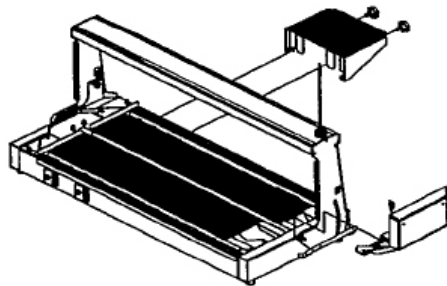

WATER PUMP INSTALLATION

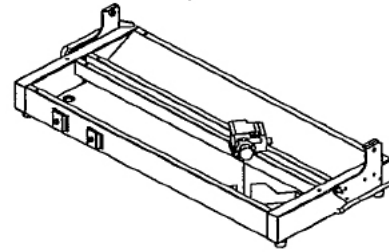

1. Remove the water pump from the box and check that it is not damaged.
2. Place the pump into the bracket at the right front corner of the water tray along its side so that the water outlet is positioned horizontally. Connect the water hose from the blade guard to the pump and plug the power cord into the 3-prong receptacle.
3. Fill the water tray so that the water intake is fully immersed.
4. Be sure to support the pump during installation to prevent pump failure or damage.

WATER LEVEL TUBE

A tube at the rear end of the saw filters the debris from the water produced during cutting operation. Debris settles in the water tray while the water is allowed to pass through the tube and into the water bucket, where fresh and filtered water resides.

1. Remove the water level tube from the plastic bag.
2. Insert the thin end of the tube into the rear hole next to the water pump, as shown in the illustration.
3. Fill the water tray with water.

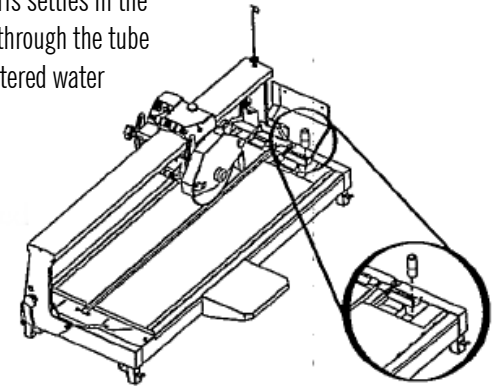

WARNING

DISCONNECT THE PUMP BEFORE ATTEMPTING TO HANDLE THE PUMP.
NEVER OPERATE PUMP WITHOUT WATER IN THE TRAY.

THE RIP GUIDE

The MasterGuide is a two piece assembly consisting of a template base and a unique detachable ruler guide. This permits any cutting angle between 0° and 45°, with 22° and 30° clearly designated. The ruler guide also doubles as a measurement tool to accurately measure slabs up to a foot in length. The MasterGuide has a locking mechanism that secures the ruler guide firmly to the template base.

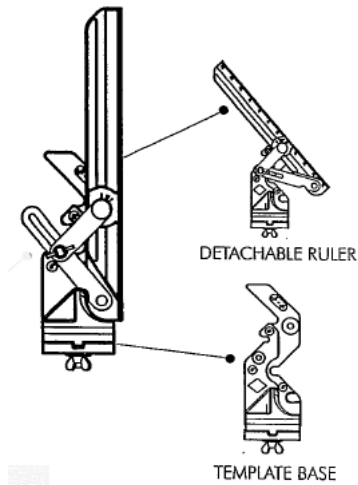

WARNING

ALWAYS LOCK THE RIP GUIDE PRIOR TO TRANSPORTING THE SAW

OPERATING THE SAW

1. After you have made yourself familiar with the components of your saw, the machine has been properly set up, the bucket or water tray is filled with water, and electrical connection is established accordance with the relevant safety regulations, you may now begin with the cutting operation.
2. Before you start operation open the water shut-off valve.
3. During the operation, the user must stand in from side of the saw, holding the handle of the swivel-joint cutting head with his left hand. The workplace must rest on the work table and should be pressed highly against the side and limit stops with the right hand.
4. Always turn off the saw before you leave the machine unattended.

OPERATING THE SAW: CONTINUED

5. After the cutting operation is finished, prevent accidental restarting of the saw by pushing the emergency stop from the switch bracket and unplugging the power cable.

CUTTING AT CONSTANT DEPTH

When cutting at constant depth the cutting head must be pulled against the workpiece.

1. Before you start cutting, set the cutting head at the desired fixed cutting depth.
2. Then use the handle slowly and uniformly along the guide rail and across the workpiece.
3. Push the cutting head fully back after you finished the cut.

PLUNGE CUTS

The handling of larger cutting depths can be simplified using the plunge cutting method.

1. In this case, the cutting head will not be set to a fixed position while performing the cut.
2. As you have not fixed the saw at a defined depth, the cutting head is freely movable during seesaw operations.
3. Hold the handle of the cutting head with your left hand and move it to and fro across the workpiece while lightly pressing the cutting head downwards in a discontinuous

THE CUTTING TABLE

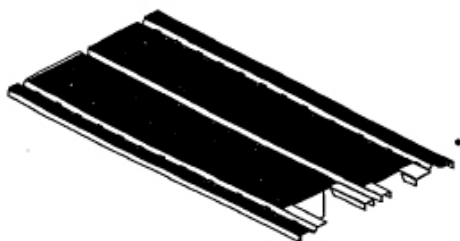

FEATURES

- The easily removable cutting table is covered with an anti-skid rubber coating, which allows the material being cut to sit still on the table while cutting head is pulled through it.
- Simply line up the material being cut with the appropriate pre-marked lines on the cutting table.

STEPS TO MAKE MITER CUTS:

1. The bench saw is equipped with a hinged guide rail that allows the user to make accurate mitre cuts.
2. To pivot the guide rail, lightly loosen the palm grips of both front sides of the saw.
3. Set the rail to the desired angle.
4. Firmly re-tighten the palm grips after setting the guide rail.

CUTTING DEPTH

The recommended cutting depth is $\frac{1}{4}$ " below the cutting table surface. The cutting clearance has been fixed from original designed.

Blade Diameter	Cutting Depth
8"	1-1/2"
10"	2-5/8"



WARNING

SETTING THE BLADE TOO LOW MAY DAMAGE THE CUTTING TABLE AND IF SET TOO HIGH, THE BLADE MAY GRAB THE MATERIAL BEING CUT. CAUSING DAMAGE AND POSSIBLY INJURY.

CHOOSING THE RIGHT BLADE

1. The blade shaft speed of this saw is exclusively designed for cutting with diamond saw blades. The saw may only be used for cutting natural and artificial stone materials, do not cut wood or metal.
2. The saw uses diamond saw blades with diameters up to 10". Saw blades with larger diameters must not be installed on the saw.
3. Choose the correct type of saw blade for the material to be cut and the required cutting depth.

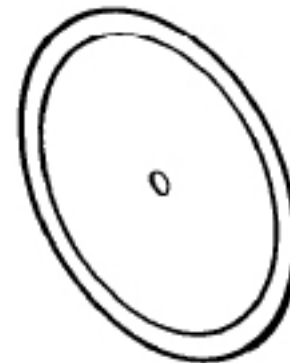

ELECTRIC MOTOR SPECIFICATIONS

- Horsepower 1-1/2 H.P.
- Volts 115 V
- Amps 15 Amps
- Motor RPM 3450
- Cycle 60Hz
- Phase 1

RECOMMENDATIONS:

- It is recommended that a 15 AMP CIRCUIT be used while operating this saw. This will prevent any loss of power or interruption.
- Always plug saw as close as possible to the power source while operating. This will allow you to receive optimum electricity.

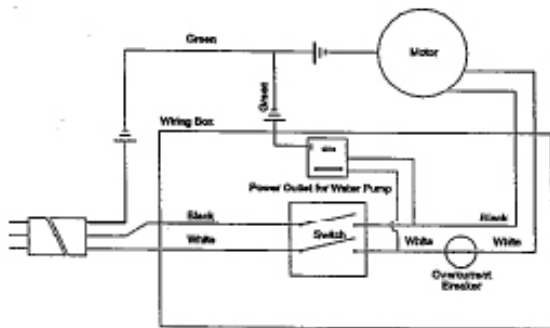

WIRE GAUGE	LENTGH OF CORD 1-1/2 HP - 115V
NO. 12	25'
NO. 10	50'
NO. 8	75'



WARNING

TO AVOID PERMANENT MOTOR DAMAGE YOU MUST USE THE CORRECT EXTENSION CORD. NEVER USE MORE THAN ONE EXTENSION CORD AT A TIME. FOLLOW THE CHART FOR PROPER SIZE.

OPTIONAL ACCESSORIES

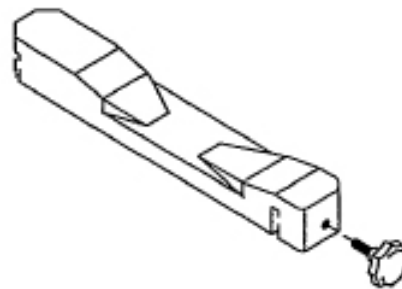

45° / 90° RIP GUIDE

Part No. S1000-35N

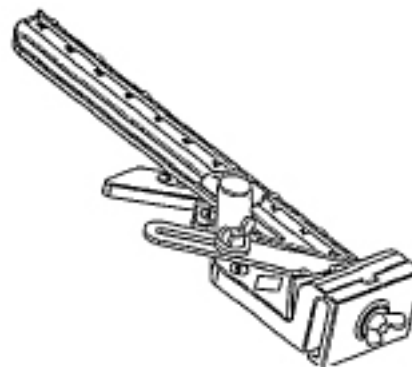

MASTER GUIDE

Part No. S1000-MG

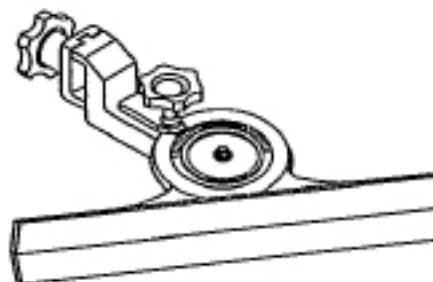

ANGLE GUIDE

Part No. S1000-44

DO'S & DON'TS FOR BLADES

Wet Cut Blades

DO'S

- Inspect blades daily for cracks or uneven wear
- Always use appropriate blade for material being cut.
- Inspect arbor shaft for uneven wear before mounting blade.
- Always use blades with the correct arbor shaft size.
- Ensure that blade is mounted in the correct direction.
- Secure the blade to the arbor with a wrench.
- Use proper safety equipment when operating the saw.
- Periodically check the blade for cracks or bond fatigue.
- Always have a continuous flow of water on both sides of blades.

DON'TS

- Do not operate the saw without safety guards in position.
- Do not operate the saw with blades larger than 10".
- Do not cut dry with blades marked "USE WET".
- Do not exceed manufacturer's recommended maximum RPM.
- Do not force blade into material let blade cut at its own speed.

DO'S & DON'TS FOR BLADES

Dry Cut Blades

DO'S

- In addition to the following , always follow wet recommendations.
- Use appropriate blade for material being cut.
- Inspect segment blades for segment cracking or loss.
- Do not use damaged blades.
- Use proper safety equipment when operating the saw.

DON'TS

- In addition to the following, always follow wet recommendations.
- Do not make long cuts with dry blades-allow them to air cool.
- Do not use the edge or side of blade to cut or grind.
- Do not attempt to cut a radius or curve.
- Do not cut too deep or too fast into the material.
- Do not cut any material not recommended by blade manufacturer.



WARNING

FOR YOUR SAFETY, BEFORE PERFORMING ANY MAINTENANCE ON THE SAW TURN OFF THE POWER SWITCH AND UNPLUG THE POWER CORD.

GENERAL RULES

- Always clean the machine before maintenance/repair.
- Before cleaning/maintenance/repair, the machine must be switched off with the main power key.

STEPS TO FOLLOW WHEN:

CLEANING:

- Please do not use aggressive cleaners (i.e. containing solvents). Do not use high-pressure water jets, aggressive detergents or solutions and liquids with a temperature exceeding 86 F. Use a fluff-free cloth only.
- Use a cloth which may be lightly moistened only for removing dust and dirt. Hard packed dirt can be removed with a soft brush.
- For the sake of safety, no water/cleaning liquid/vapor may penetrate into the electric motor, connectors/plugs, switches, etc.

Therefore cover all apertures, holes in the housing connectors or plugs, etc. or seal them with adhesive tape!

- Use a soft, low-pressure water jet and a brush to rinse dirt and incrustations away. Be particularly careful when near hazardous parts of the machine (e.g. switch, motor). Clean the motor and switches only by wiping with a moist cloth.

- Do not “rinse” the bearings of the drive elements to prevent them from running dry. The ball bearings of the machine are permanently lubricated.
- After cleaning, remove all covers and adhesive tape. All screws/nuts which you may have loosened must be tightened again.

- After wet cleaning, try the machine on a power outlet which is equipped with a power breaker (i.e. fault current circuit breaker). If the fault current circuit breaker cuts the power supply, the machine must be inspected by an authorized dealer prior to use.

CLEANING:

After every use of the machine:

- Remove dirty water from container.
- Remove dirt and mud from the bottom of the container.
- Rinse the immersion pump with fresh water to prevent water pump clogging from residual dirt.

After wet cleaning and before using the machine again:

- Connect the machine to an electric power outlet equipped with a “GFCI” safety power breaker. If the safety power breaker cuts off the electrical power supply, do not try to operate the machine but have it checked by an authorized dealer first.

BEFORE & AFTER A PROLONGED TIME

Before not using the machine for a prolonged period of time:

- Clean and lubricate all movable parts.
DO NOT GREASE THE GUIDE RAILS.

After not using the machine for a prolonged period of time:

- Check that the legs are safely fixed.
- Check that the roller table is in its guides and that it easily moves to and fro.
- With the saw blade, removed switch on the motor for an instant and switch it off again. If the motor does not run, have the machine inspected by a qualified electrician.

After not using the machine for a prolonged period of time:

- Check that the immersion pump works properly. Turn on the cooling water tap and switch the machine on. If the pump does not give any water or only a little, switch the machine off at once. Clean the pump, or replace if necessary.

TEMPERATURE CHANGES

**Ambient Temperature
Below 37° F (Winter)**

- To prevent the water in the pump and cooling system from freezing, remove the water after using the machine or when there will be a long break. Make sure that the cooling system is entirely drained so that there is no water left inside the pump, the bearing house and water hose.

WATER PUMP MAINTENANCE

When the machine has not been used for a long period of time, hard packed dirt may bein to build up inside the pump and block the pump wheel. If the machine is activated with the immersion pump blocked, the electric motor of the pump will be damaged within a few minutes! Please follow the steps listed below to clean the pump before operating the saw.

1. Unscrew the pump filter.
2. Remove the immersion pump from the water container.

3. Clean the immersion pump.
4. Loosen the fixing screws of the pump lid.
5. Take the lid off the pump (be careful not to damage the gasket located inside with a sharp object)
6. Clean the pump lid
7. Remove all dirt and incrustations from the pump wheel.
8. Check whether the pump wheel can be easily turned.
9. Then reassemble the immersion pump correctly and check whether it works properly.

TROUBLESHOOTING

PROBLEM	POSSIBLE CAUSE	SOLUTION
Machine does not run when switched on	Power cord not properly fixed/plugged in	Check that the machine is properly connected to the power supply
	Power cord defective	Have the power cord checked, replace if necessary
	Main power switch defective	Have the main power switch checked and replace if necessary by a qualified electrician.
	Loose electrical connection inside the electric system	Have the whole system of the machine checked by a qualified electrician
	Motor defective	Have the motor checked and replaced it necessary by a qualified technician
Motor stops (power cut off)	Too much pressure exerted while cutting	Exert less pressure when cutting
	Incorrect specification for saw blade	Use a saw blade which corresponds to the material being cut
	Saw has defective electric system	Have the electric system of the saw checked by a qualified technician
Poot machine performance little power	Power cord/extension cable too long or cable still wound up inside cable drum.	Use a power cord/extension cable of the rated length use a cable drum with cable fully extended
	Power network is insufficient	Observe the electrical ratings of the machine and connect it only to a power network which complies with these ratings.

TROUBLESHOOTING

PROBLEM	POSSIBLE CAUSE	SOLUTION
	Drive motor no longer runs at rated speed (r.p.m.)	Have the motor checked by a qualified electrician and have it replaced if necessary
Insufficient flow of cooling water or no cooling water at all	The pump draws air Filter clogged	Fill the container with water Clean the filter of the pump
	Pump wheel of the immersion pump blocked by dirt	Disassemble the immersion pump and clean
Irregular run of the saw blade	Poor tension in the blade material	Return the saw blade to the manufacturer
Saw blade wobbles when running	Saw blade is damaged or bent	Have the saw blade aligned/flattened clean the receiving flange. Solder the diamond segments of the old blade onto another saw blade or use a new blade
	Flange of the saw blade is damaged Shaft of the motor is bent	Replace the saw blade flange Replace the electric motor
Diamond segment becomes loose	Overheating of the saw blade; cooling water not sufficient	Have the diamond segment soldered on the blade again; ensure optimum flow of cooling water
Excessive wear	Wrong type of saw blade Shaft of motor causes wobbling Overheating	Use harder saw blades Have bearings of the motor or the motor replaced
		Ensure optimum flow of cooling water

LIMITED WARRANTY

SAW

For a period of one (1) year from the original date of purchase, if the product is determined to be defective, we will repair or replace the product, at its option, at no charge to the customer, or pay the associated repair costs to an authorized service facility. All replacement parts, new or rebuilt, supplied at our option for repairs will be warranted for the remainder of the original warranty period of one (1) year. All defective products or components replaced under this limited warranty excludes all components not manufactured by OUR COMPANY, which are listed below with their corresponding independent warranty periods. Such components are warranted by their respective manufacturer, whose warranty will be the governing warranty for that particular product.

Excluded Components	Manufacturer's Warranty
Electric Motors	1 year
Water Pumps	Varies by Model See Accompanied Warranty for details.

BLADE BOUGHT FROM OUR COMPANY:

If the bond between the steel core and segment or rim fails during the normal useful life of the blade, we will replace the blade at no cost to the customer.

This warranty does not cover cosmetic damages or damages due to (1) misuse, abuse, negligence, accident, or modifications of the product or any of its components; (2) improper operation or failure to provide reasonable maintenance; or (3) attempted repair by any party other than an authorized service facility. All products are subject to wear and tear under normal use. As such, the customer is responsible for all costs associated with the maintenance of said product, including the purchase of replacement components thereof.

LIMITED WARRANTY

To obtain warranty service, you must take the product or deliver the product freight prepaid, in either its original packaging or packaging affording an equal degree of protection, to service facility authorized by us, along with proof of purchase in the form of a bill of sale, within the warranty period specified above. Warranty may be void if additional damages are incurred during transportation due to inadequate packaging.

WE shall not be responsible for or obligated to pay for freight or other transportation related costs or expenses in connection with any defective products or components that are either returned to OUR facility or any authorized repair station and/or any replacement products or components that are shipped from OUR pursuant to this Warranty.

OUR COMPANY SHALL NOT BE LIABLE FOR ANY INCIDENTAL OR CONSEQUENTIAL DAMAGES FOR BREACH OR ANY EXPRESS OR IMPLIED WARRANTY, OR NEGLIGENCE, SUCH DAMAGES INCLUDE, BUT ARE NOT LIMITED TO, LOSS OF PROFITS, LOSS OF REVENUE, LOSS OF USE OF THE PRODUCT, AND DOWN TIME. OUR LIABILITY SHALL NOT EXCEED THE REPLACEMENT COST OF ANY DEFECTIVE PRODUCT OR COMPONENT THEREOF. THIS LIMITED WARRANTY IS IN LIEU OF ALL OTHER WARRANTIES, WHETHER EXPRESSED OR IMPLIED.

EXCLUSION FROM WARRANTY

WE cannot assume responsibility for claims arising from abuse of OUR product.

- Due to abuse by the Purchaser in their processing.
- Due to improper installation practices or procedures.
- Due to abuse or improper usage by the end-user.
- Due to contaminants, including, but not limited to, exposure to salt or fresh water, chemicals and any other form of contamination from a source outside of OUR control.

REPLACEMENT PARTS LIST

PART NAME	PART NO.
1. Guide Rail	102701
2. Ruler Guide Bolt (set of 4) M6X16	102702
3. Supporting Post Lock Bolt (set of 6) M5X20	102703
4. Ruler Guide	102704
5. Angle Adjustment Lock Knob	102705
6. Front Support Post Plate	102706
7. Center Lock Nut (set of 2) M10	102707
8. Front Rubber Mat Cutting Table	102708
9. Drain Plug	102709
10. Main Metal Frame	102710
11. Water Pump	S100027
12. Cable & Hose spring Hanger	102712
13. Extension Table Lock Knob	102713
14. Side Extension Table	102714
15. Side Splash Guard	102715
16. Rear Rubber Cutting Table	102716
17. Splash Guard Wing Nut/M6	102717
18. Back Water Splash Guard	102718
19. Cable & Hose Position Bracket	102719
20. Angle Adjustment Bolt (set of 2) M6X20	102720
21. Rear Support Post Plate	102721
22. Angle Adjustment Knob	102705
23. Water Flow "Y" Adapter	102723
24. Water Control Valve	3502
25. Blade Guard Lock Knob	102725
26. Blade Guard	102726
27. Water Splash Guard	102727
28. Blade Lock Nut / M12	102728
29. Outer Flange	102729
30. Motor Mounting Lock Bolt (set of 4) M8X16	102730
31. Motor Cutting Angle Screw/Hex 250 M10	102731
32. Handle Rubber Sleeve	102732
33. Motor Cutting Angle Adjustment Screw / Hex Screw 235 M10	102733
34. Tension Spring	102734
35. Cutting Head Carrage Bracket	102735
36. Handle Bar	102736
37. Handle Rubber Sleeve	102732
38. Cutting Head Position Bracket	102738

REPLACEMENT PARTS LIST

PART NAME	PART NO.
39. Motor Position Lock Knob	102739
40. Circuit Breaker	102740
41. Toggle Switch	102741
42. Switch Housing Control Panel	102742
43. Switch Housing Complete Set	102743
44. Cable Protective Rubber Sleeve	102744
45. Adjustment Guide Wheels (set of 2)	102745
46. Cutting Height Adjustment Lock Knob	102746
47. Lock Nut/M10	102747
48. Power Cable / 14AWG	102748
49. 1-1/2 HP Motor	102749
50. Motor Mounting Bracket	102750
51. Cutting Table Head Travel Bumper	102751
52. Inner Flange	102752
53. Diamond Blade	
54. Angle Adjustment Screw (set of 2) Nut M6	102754
55. Adjustment Guide Wheels (set of 3)	102755
56. Rolling Wheel	102756
57. Multipler Wrench	102757
58. Masterguide Template Base	S1000-MG1
59. 180° Adjustment Angle Guard	S100044
60. Water Pump Adapter	102760
61. Slide-In Legs with Wheels (set of 2)	102761
62. Masterguide Detachable Ruler Guide (Optional)	S1000-MG2
63. Masterguide Multiangle Guide	S1000-MG
64. Slide in Legs (set of 2)	102764
65. Rubber Wheel	102765
66. Slide in legs wing Nuts (set of 4)	102753
67. Water Level Tube	102724
68. Long Hose	102758
69. Plastic Water Nozzle	102769
70. Water Nozzle Plate	102770
71. Spring Clip	102771
72. Side Splash guard wing nut (required 2)	102722
73. Longer Leg /wheel (set of 2)	103761
74. Leegs (set of 2)	103764

NOTE: If there is any part that is needed and has not been included in this parts list, please contact our customer service.



CUSTOMER SERVICE

AFTER SALE SERVICE

All customer service (technical questions, re-order of parts, etc.) will be provided by our company.

All spare parts for after sales service will be stocked and shipped from our warehouse.

If requested, we may arrange for our sales representative to hold a training class for product knowledge at dealer's location.

HOW TO ORDER:

INFORMATION NEEDED FOR ORDERING:

- Serial Number of the Saw
- Model Number of the Saw
- When it was purchased and where
- Part Description

If you need to order replacements parts, please contact our customer service department. You can reach us at the contact information below.

Customer Service Department:

Phone: (800).227.0601

Web: www.orcon.com

DISCLAIMER:

ORCON reserves the right to make changes or improvements on its products without incurring on additional obligationi including any obligation to make corresponding changes or improvements to products previously manufactured or sold. ORCON reserves the right to discontinue products at any time without notice.

CONTACT US

We pride ourselves on our customer service. If you have any questions regarding our products, whether it may be product inquiry or troubleshooting, please don't hesitate to contact us at our corporate office. We will do our best to answer your questions. In some cases we may even refer you to a local sales representative that can better service you. You can email or call us at the contact information listed below



P R O D U C T S

Customer Service Department:

Phone: (800).227.0601

Web: www.orcon.com

ALL ILLUSTRATIONS DISPLAYED IN THIS MANUAL ARE PROPERTY OF ORCON AND SHALL NOT BE
DUPLICATED OR REPRODUCED WITHOUT THE EXPRESS WRITTEN CONSENT OF ORCON.